

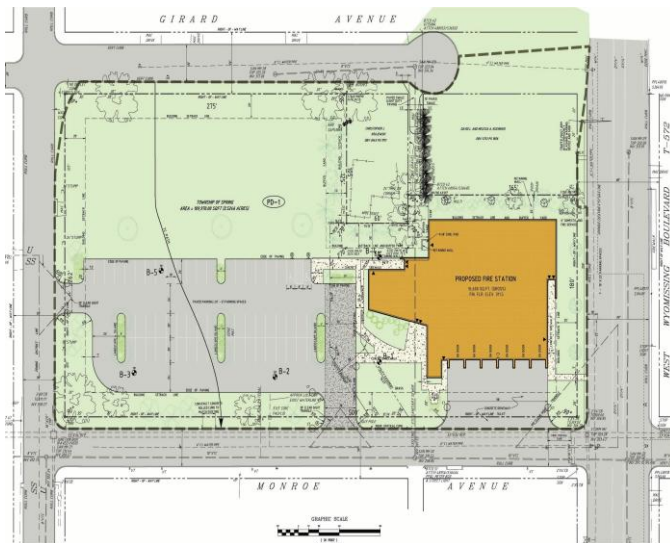

Fire Station



Site Layout

This project included site layout and design to accommodate a 16,600 sq. ft. Fire Station and associated parking, maneuvering and storage areas. The key element to this project was siting the building for ease of access for emergency vehicles.

The project scope included the following services:

- Site Boundary and Topographic Survey
- Site Planning
- Grading
- Utility Relocation and Design
- Landscape Design
- Municipal and County Approvals
- Erosion & Sediment Control
- NPDES Permitting
- Construction Documentation and Administration

Fire Station
Township of Spring, Berks County, PA